

# **Burlington VegFest FAQs: Guest's Edition**

We know you have lots of questions, so we have tried to answer them all here! Can't find the answer you need? Feel free to send us an email at [burlingtonvegfestcanada@gmail.com](mailto:burlingtonvegfestcanada@gmail.com).

## **What is Burlington VegFest all about?**

Burlington VegFest is a one-day festival celebrating compassionate, healthy and sustainable living.

## **Is the event free?**

Yes! The event is free of charge but visitors are encouraged to support our Vegfest Food Drive, with all donations going to the Burlington Food Bank. To save you from carrying non-perishable food items to the VegFest (and to ensure our donations are 100% vegan), we're accepting cash donations at <https://www.burlingtonvegfest.com/local-food-bank>. And for every \$10 donation, you'll receive a raffle ticket for an opportunity to win a cool prize!

## **Is this an outdoor event?**

Yes, rain or shine - unless the weather poses a threat to the safety of our vendors and attendees. And if that's the case, we'll post information on our website and Facebook, and notify vendors via email on the morning of the event.

## **Will everything be vegan?**

Yes, this festival is 100% vegan.

## **Vegan Policy**

Everyone is welcome to attend Burlington events as a visitor, regardless of their current dietary, lifestyle, political or philosophical status. Burlington VegFest welcomes people who are vegan, transitioning, curious or completely new to the whole concept. People who currently choose to use animal products will be very welcome to attend (and we can almost guarantee they will be amazed by the abundance and awesomeness of vegan products)!

## Which payment methods will vendors be accepting?

Most exhibitors will take credit or debit cards, but some are cash only. **Please note, there is NO ATM on site**, so it's recommended that you bring some cash - just in case that item you really want is cash only! Please note there is a Social Bank across the street.

## What else should I bring to Burlington VegFest?

We recommend bringing a reusable bag (for items) and a reusable water **bottle (to stay hydrated)**. Consider bringing a folding chair and/or blanket to set up near the stage and enjoy a picnic with your friends & family while listening to the band and our speakers.

## Will there be parking at the event?

While there are two small parking lots at Burloak Waterfront Park, they are reserved for those with accessible parking permits, event organizers and food trucks. However, Burlington VegFest has secured 150 parking spots for vendors, speakers and attendees at Lakeside Shopping Village (5353 Lakeshore Road), across the street from the park. Please refer to the map below, as long as you park in one of the 150 highlighted spots - parking is free!

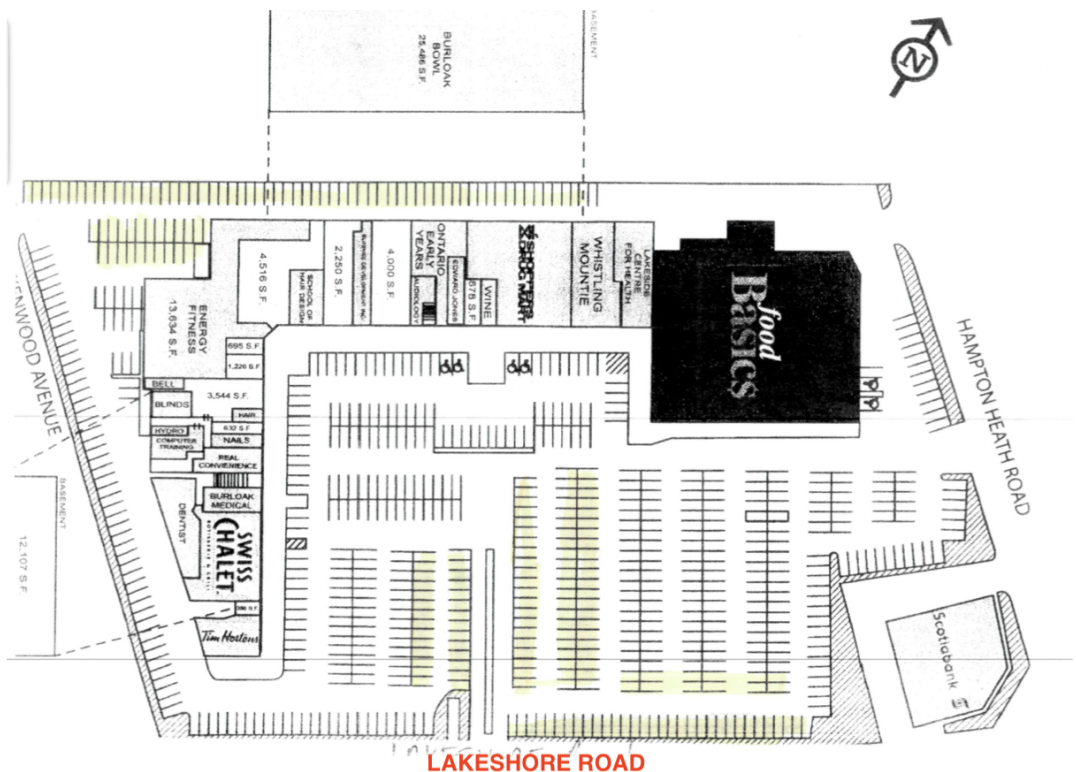

## **Is there transportation to Burlington VegFest?**

We are running a FREE Shuttle from Appleby GO Train Station! Burlington VegFest is also on a public bus route. [Here](#) is a handy app to help you get there!

## **How do I get to Burlington VegFest if I'm driving?**

### ***Here's the address:***

Burloak Waterfront Park  
5420 Lakeshore Rd,  
Burlington, ON L7L 1C9

### **From Toronto**

- Take Gardiner Expressway, Queen Elizabeth Way and ON-403 West
- Exit on Burloak Drive (exit 109) and go south to Lakeshore Road
- Turn right on Lakeshore Rd

### **From Hamilton**

- Take ON-403 East
- Exit on Burloak Drive (exit 109) and go south to Lakeshore Road
- Turn right on Lakeshore Rd

### **From London**

- Take ON-403 East and merge onto ON-401 East
- Keep right at the fork to continue on ON-403 East
- Follow signs for Brantford/Hamilton/Niagara Falls
- Use the right lane to take exit 109 for Burloak Drive
- Go south on Burloak Drive to Lakeshore Road
- Turn right onto Lakeshore Road

### **From Guelph/Cambridge/Waterloo**

- Take ON-6 S and ON-403 E to Burloak Drive/Halton Regional Rd 21 in Burlington
- Take exit 109 for Burloak Drive -
- Go south on Burloak Drive to Lakeshore Road
- Turn right onto Lakeshore Road

## **Can I bring my companion dog?**

Absolutely! Of course, dogs must be leashed, and you will be responsible for cleaning up after them, but there will be garbage bins throughout the park, as well as hand-washing stations.

**Can I opt out of being in any pictures or videos during the event?**

We are expecting lots of pictures and video to be taken at the event! As with any public space, please be aware that you may be in some of the shots taken at VegFest.

**Will alcohol be served?**

No alcohol consumption is permitted, as per the City of Burlington By-Law.